

[MLS #2708107](#)

Iolani Banyan

2575 Laau Street #103

Honolulu, Hawaii 96826

560 square foot 1 bedroom

56 square foot partially enclosed private lanai

1 Rented Parking Space

List Price \$33,000 Leasehold

Lease Rent \$210/month

Lease Expires 12/04/2012

Maintenance Fee \$207/month

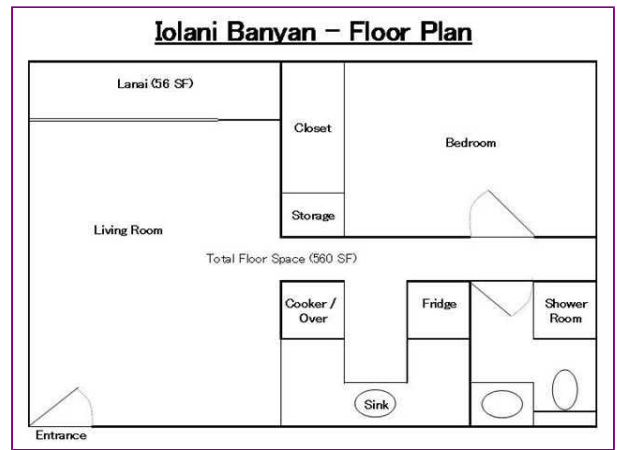

The Iolani Banyan is located in a convenient area in Honolulu. It is walking distance to schools, restaurants, businesses & bus routes. The in town convenience is also coupled with the ease of accessibility to this ground floor corner unit of a well maintained, walk-up, co-op apartment. Located at 2575 Laau Street, Iolani Banyan sits 1 block off Date Street, the major thoroughfare. Date Street travels through the McCully area crossing Kapiolani Blvd. & ends at Kapahulu Avenue. The main routes to Ala Moana Shopping Center or Waikiki and the Waikiki Beach area.

The Iolani Banyan grounds are well kept. A sparkling blue swimming pool is also part of the Iolani Banyan. Lush tropical gardens encompass the sundeck and pool area for a tranquil feeling of solitude in the middle of "town".

Leasehold co-operative apartments are not like most properties on the market. If you have any questions about leasehold or co-operative apartments, please inquire with me or consult your Realtor and or attorney. The lease term here could fit your needs. It may be suitable for someone who visits Honolulu frequently for business or pleasure, someone on a fixed budget for the next several years and doesn't want to commit to a conventional mortgage, a college student who would prefer to be off campus, someone who needs a place to stay while shopping for a more permanent condo or house or someone who is renovating their condo or house. The scenarios are plentiful. Consult a financial advisor or an accountant to see if it could work to your benefit.

MLS #2708107 Listing courtesy of East Oahu Realty, Inc.

